

Optisky

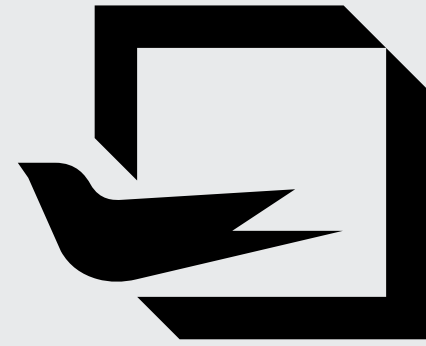

OPENING
NEW
HORIZONS

+29
years of experience

+55.000

square meters

+2.500

partners



Optimedia has been producing PVC and Aluminum joineries since 1994, amassing an impressive and modern production system. Since 2006, we have started exporting our products currently having more than 2.500 B2B partners worldwide.

OUR VISION:

To be a leader in the production of PVC and Aluminum joineries, offering support to all our partners. To achieve this, we have kept to our core principles, maintaining the quality of our products and the relationships with our partners as top priorities.

OUR MISSION:

To produce windows and doors that have certified and proven characteristics, manufactured and delivered to the highest market standards.



REYNAERS, is a european leader specialized in the development of innovative and sustainable aluminum solutions. Their product offering ranges from curtain walls to windows, doors and even sliding or folding joinery systems.

reynaers.com



CORTIZO has consolidated its leading position on the aluminum market for architecture and construction profiles through massive investments that have allowed it to create a complete range of solutions for windows, facades and state-of-the-art solar protection systems.

cortizo.com



GUARDIAN GLASS is one of the largest and most innovative glass manufacturers in the world. Founded in 1932 in Detroit, Michigan, the company operates on five continents, serving more than 160 countries.

guardianglass.com



SAINT-GOBAIN GLASS is the european leader in the production of construction glass. The factory in Călărași, Romania, has the most modern float glass production line in Europe. The thermal, acoustic and security performances of SAINT-GOBAIN glazings recommends them for the most creative and original architectural solutions.

saint-gobain-glass.com

OptiSky

COR TP 52

PRODUCT GEOMETRY

Mullion visible width: **52 mm**
Mullion depth: **16 - 250 mm**

MAXIMUM INSULATING GLASS UNIT THICKNESS

64 mm

THERMAL PERFORMANCE

$U_f \geq 0,6 \text{ W/m}^2\text{K}$

CERTIFICATIONS

Air resistance: **Class AE**
Water resistance: **Class RE1350**
Wind resistance: **Class UNE-EN 13116:2001**



The new generation of CORTIZO facades offers a wide range of mullions and transoms, adapting to the diverse aesthetic and technical needs present in architecture. The TP 52 facade ensures excellent thermal and acoustic performances thanks to its ability to incorporate insulating glass units up to 64 mm thick and the continuous pressure plate profiles that support the glass on all sides. Both the outer and inner profiles have a 52 mm thick section, ensuring a continuous design.

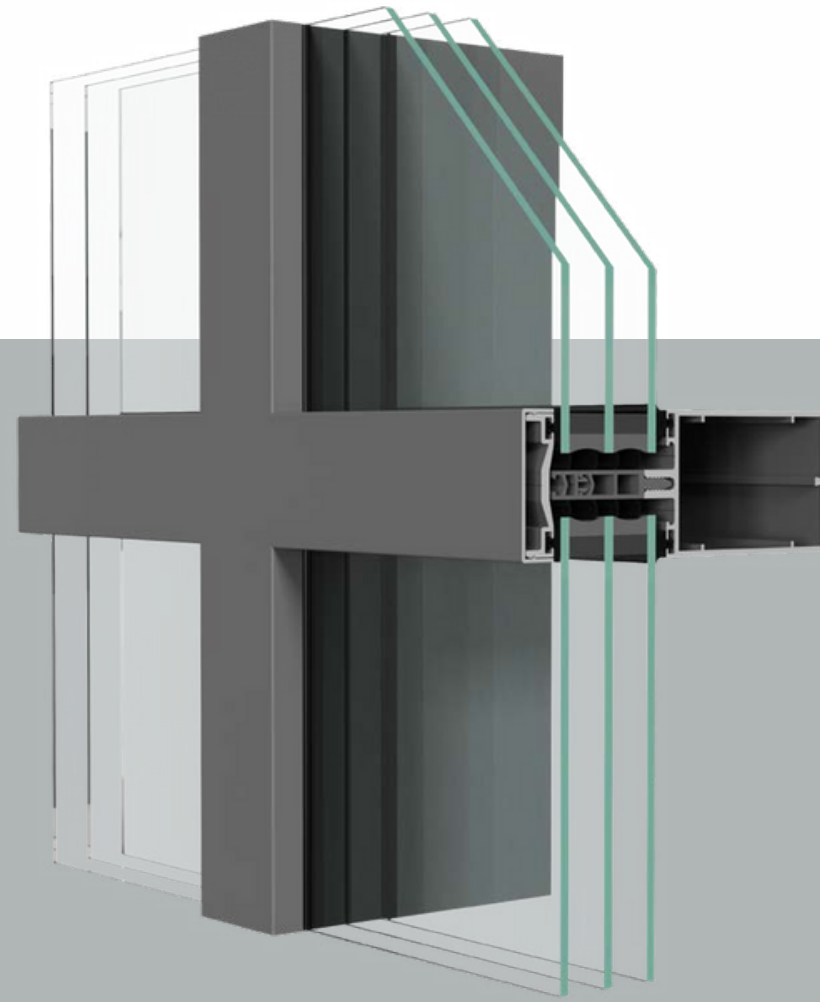

* THE PHOTOS ARE FOR INFORMATIONAL PURPOSES ONLY.



OptiSky

CONCEPTWALL 50

PRODUCT GEOMETRY

Mullion visible width: **50 mm**
Mullion depth: **42 - 300 mm**

MAXIMUM INSULATING GLASS UNIT THICKNESS

60 mm

THERMAL PERFORMANCE

$U_f \geq 0,56 \text{ W/m}^2\text{K}$

CERTIFICATIONS

Air resistance: **Class 1200**
Water resistance: **Class E1200**
Wind resistance: **Class E2400**



ConceptWall 50 is a curtain wall facades and roofs system standing out through its high execution and installation speeds, almost unlimited configuration possibilities and extraordinary performance levels. In addition to the varied range of configuration options, the system guarantees thermal performance at the passive house level.

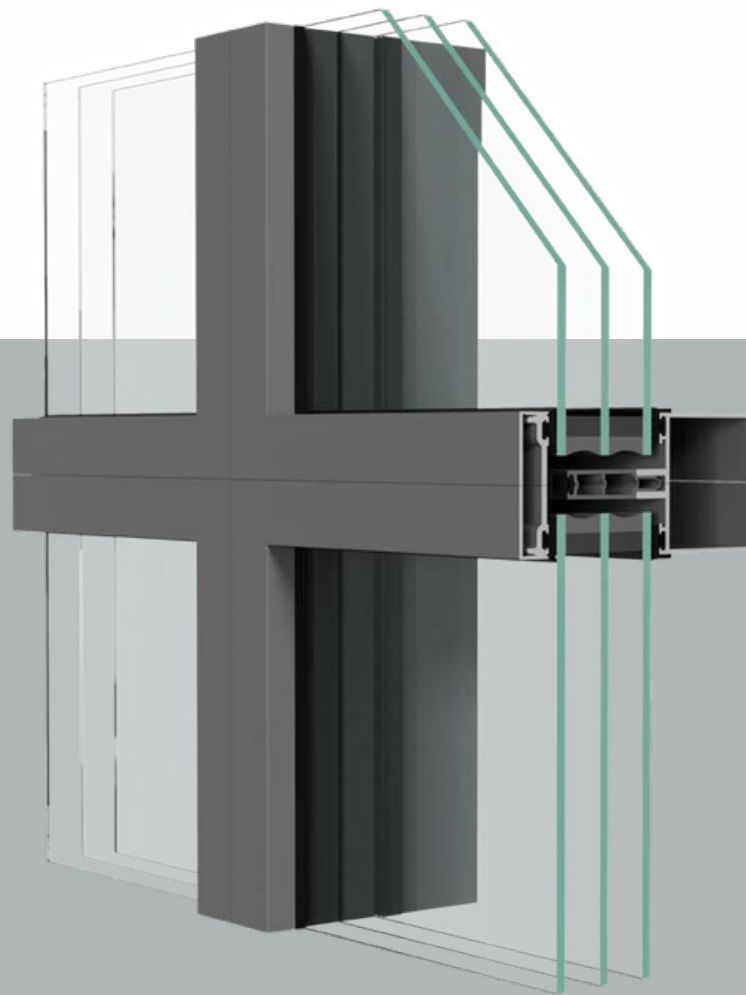

* THE PHOTOS ARE FOR INFORMATIONAL PURPOSES ONLY.



Glass

Glass represents approximately 80% of the a joinery's surface. OPTIMEDIA equips its products with SAINT GOBAIN GLASS or GUARDIAN glazings that meet the thermal, acoustic and security requirements, whilst ensuring the desired indoor ambiance. Their winter-summer comfort function maintains a pleasant interior atmosphere throughout the year, with the sheen of its coating giving the space a touch of elegance.

TECHNICAL SPECIFICATIONS

ESG tempered glass is, on average, 4 times more resistant than a standard glass to changes in temperature, strong winds and impacts. When cracked, it breaks down into small pieces without any sharp edges.

Laminated glass is composed of two or more simple glass sheets glued together with a PVB film which, in case of breakage acts as a medium to which the shards remain glued, therefore preventing possible accidents.

Tempered glass aims to protect both users against accidents and buildings against break-ins.

For design purposes or to protect you from prying eyes, Optimedia offers you a wide range of decorative glass with a large number of models, textures and colors.

Also, for added style and elegance, you can choose between georgian and astragal bars. These can be of different sizes, colors and shapes, made of PVC or Aluminum.



Tempered glass: Optimedia ESG

ESG is a type of glass that, following the tempering process, shows a considerably higher resistance to mechanical and thermal stresses compared to ordinary glass (including laminated glass). In case of breakage, ESG glass fragments into small pieces with blunt edges. Its superior mechanical properties recommend it for large glazed elements.

USES:

Architectural: all types of interior or exterior windows, doors and glass assemblies, consisting of independent or linked elements, facades, glazed roofs, stairs and even glass floors;

Urban furniture: telephone booths, public transport stations, parapets;

Interior furniture: table tops, shower cabins, shelves, furniture.

WHY ESG (TEMPERED) GLASS?

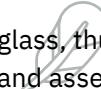
 ESG glass is 50% lighter than laminated glass, thus facilitating its transport and assembly whilst at the same time extending the joinery's life by reducing the load on the hardware.



It is 5 times more resistant to tension, shocks and bending stresses compared to an ordinary or laminated glass of the same thickness.



It reduces the risk of injury in case of breakage, by fragmenting into small, blunt pieces and limits the risk of break-ins.

OptiSky

COR TP 52

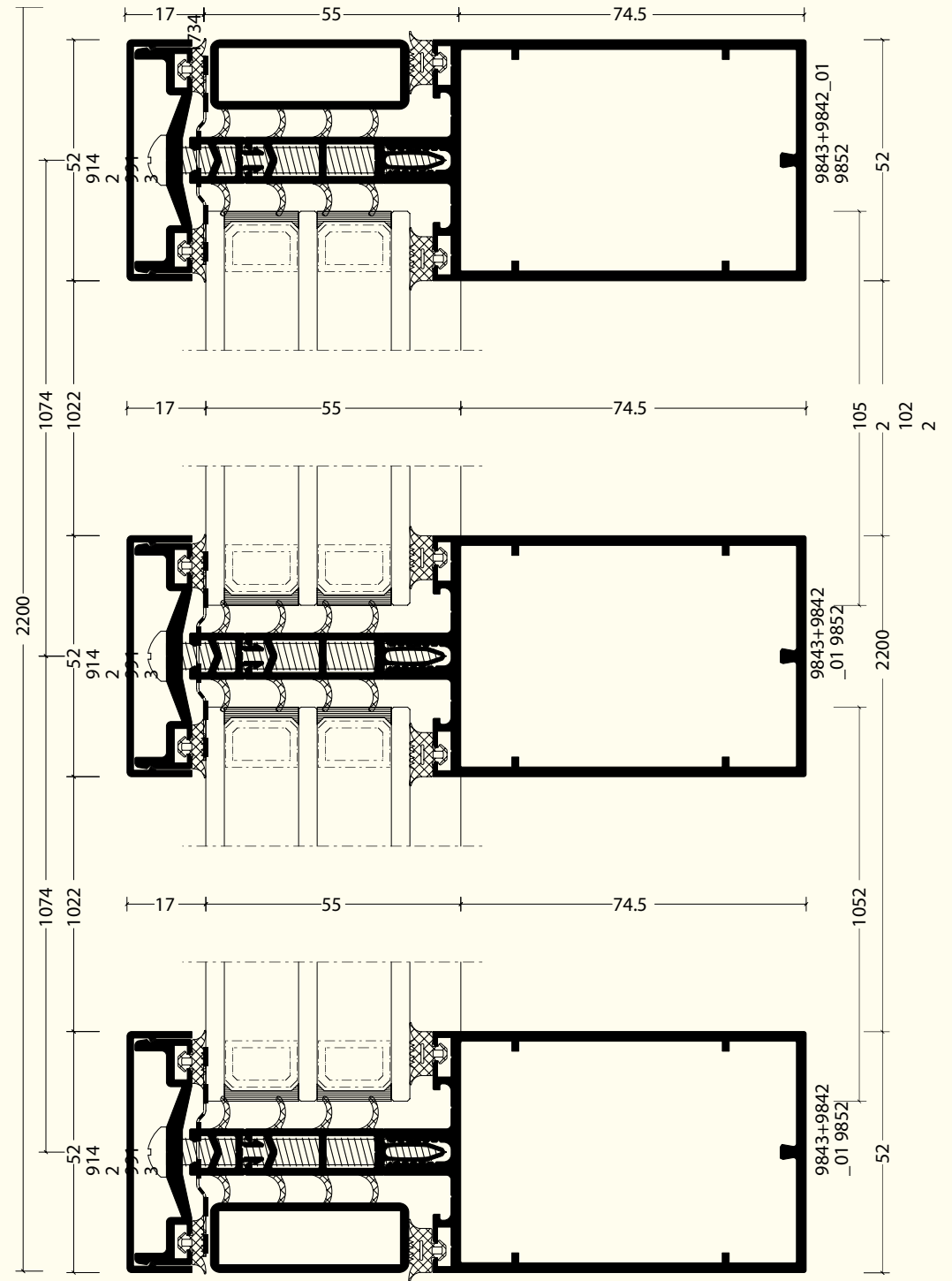

OptiSky

CONCEPTWALL 50

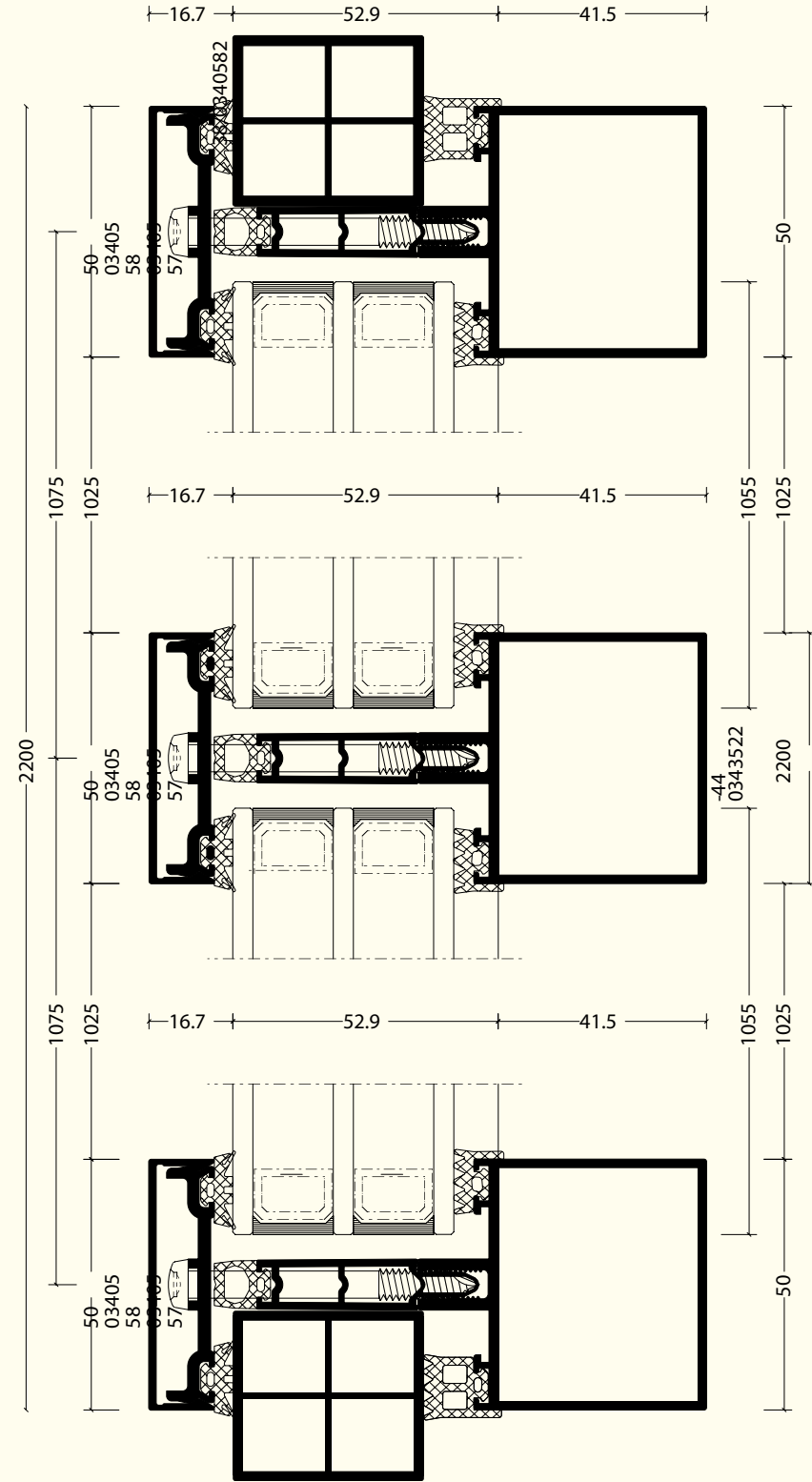

Join the Optimedia team

We are constantly recruiting agents to represent Optimedia. We export to all continents and offer extensive sales support and packages so you can be an exceptional dealer in your area.



Contact

 [optimedia](#)

 [Optimedia SRL](#)

 [optimedia.eu](#)

 [optimedia.eu](#)

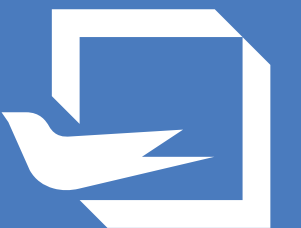



S.C. OPTIMEDIA S.R.L.
Calea Sântandrei, nr. 38
410238, Oradea, România
+40 259 442 821
worldwide@optimedia.eu

optimedia.eu